

E-Z SHELVING SYSTEMS, INC.

Manufacturer of Space-Saving

Cantilever Shelving

E-Z Shelving Systems were designed with convenience in mind. Unlike four-post shelving, E-Z's cantilever shelving decks have no post supports to get in the way, making shelf loading and unloading – E-Z!

E-Z Shelving Advantages:

1. Open-front shelving (no posts) for 100% usable space.
2. Totally usable floor space under shelf.
3. Shelving systems manufactured to any size practical allowing for custom design at no additional cost.
4. Shelf tiers are infinitely adjustable, and new tiers can be installed without disassembly.
5. Additional tiers can be added with no tear down required.
6. Shelves form a continuous back-splash which keeps stored items nested to protect both wall and stored items.
7. Systems' design assures a 1-1/4" clearance between wall and shelf allowing for ventilation and utility chases.
8. Heavy-duty industrial grade rugged construction.
9. Special ceiling brackets allowing "Spacemaker System" to be installed in walk-in coolers.
10. Shelving available in galvanized, stainless steel, aluminum and powder coat. Shelving types include; solid, louvered, wire and

SPECIFICATIONS

E-Z Uprights for Wall-Mounted Storage

Shall consist of 14 gauge rolled steel channels, continuously seam-welded electro zinc plated and chromate dipped to ensure against rust and corrosion, punched to accept 1/4" lag screws, bolts, etc., for mounting to walls. Mounting holes shall begin 2" from each end.

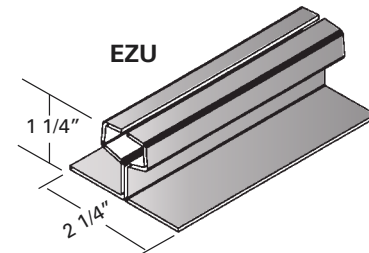

Stock upright lengths:

EZU-1	12"	EZU-6	72"
EZU-2	24"	EZU-7	84"
EZU-3	36"	EZU-8	96"
EZU-4	48"	EZU-10	120"
EZU-5	60"	EZU-12	144"

Note: Stock uprights can also be cut to your desired length. NSF-listed uprights, available in standard electro-zinc finish, series #304 stainless steel, or #6061-T6 extruded aluminum.

Note: Stainless uprights are brake formed.

Aluminum extruded uprights (part no. EZU/A) are now available.

BRACKET SPECIFICATIONS

E-Z Single Shelf Brackets (EZB) with Clamps

Shall be of 12 gauge steel electro-zinc plated and chromate dipped, after fabrication, assuring complete protection of all sheared edges. Each bracket shall be furnished with E-Z clamp assembly, zinc-plated 3/8" bolt and nut. Brackets available top flanged left or right, depending on mounting position at ends of shelving runs. See chart on page



6", 8" brackets: 2 5/8", 12 ga.
10", 12", 14" brackets: 3 1/8", 12 ga.

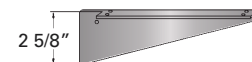

6", 8" brackets: 2 5/8", 12 ga.
10", 12", 14" brackets: 3 1/8", 12 ga.

(EZB) with Clamps (continued)

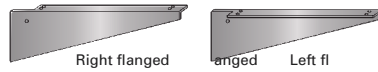

Stock bracket sizes:

EZB-6	6"	length for	6" shelves
EZB-8	8"	length for	8" shelves
EZB-10	10"	length for	10" shelves
EZB-12	12"	length for	12" shelves
EZB-14	14"	length for	14" shelves
EZB-16	16"	length for	16" shelves
EZB-18	18"	length for	18" shelves
EZB-20	20"	length for	20" shelves
EZB-22	22"	length for	22" shelves
EZB-24	24"	length for	24" shelves
EZB-26	26"	length for	26" shelves
EZB-28	28"	length for	28" shelves
EZB-30	30"	length for	30" shelves

For metal shelves use the same bracket size as shelf depth to assure match up of shelf attaching holes.

For wood shelves, use bracket length 2" shorter than the actual shelf depth. Custom bracket lengths available upon special request.

EZB denotes standard bracket style. Consult price list for NSF and stainless steel and aluminum bracket designations.

E-Z Double Brackets (EZDB) with Clamps

Shall support two adjoining shelves on a common upright. Brackets of same construction as EZB shelf bracket, with addition of a 14 gauge steel plate welded to its top horizontal flange. Double bracket shall be electro-zinc plated and chromate dipped to protect all sheared edges. Available in the following sizes specifically designed to fit the shelf size stated:

EZDB	12"	for	12"	deep shelves
EZDB	14"	for	14"	deep shelves
EZDB	16"	for	16"	deep shelves
EZDB	18"	for	18"	deep shelves
EZDB	20"	for	20"	deep shelves
EZDB	22"	for	22"	deep shelves
EZDB	24"	for	24"	deep shelves
EZDB	26"	for	26"	deep shelves
EZDB	28"	for	28"	deep shelves
EZDB	30"	for	30"	deep shelves

Other sizes available on special order.

Consult price list for NSF and stainless steel and aluminum double bracket designations.

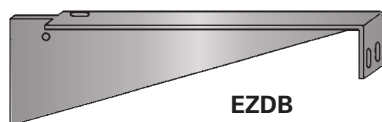

E-Z Single (EZB-K) & Double (EZDB-K) Knob Brackets

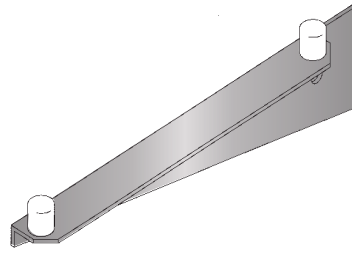

For use with wire shelving to support either a single or two adjoining wire shelves on a common upright.

Stock sizes:

12", 14", 15", 18", 21" & 24".

E-Z Single Foot (EZFB) & Double Foot (EZDFB) Brackets

For use with freestanding and back-to-back shelving systems. Brackets shall be furnished with 2 E-Z clamp assemblies, zinc-plated 3/8" bolts and nuts. Brackets shall be of 12 gauge steel, electro-zinc plated and chromate dipped. Foot brackets serve as a base for the bottom shelf. Standard height is 9 1/2".

5 1/2" H available by special order.

Stock Sizes:

EZFB	(or EZDFB)	129	12" x 9 1/2"
EZFB	(or EZDFB)	149	14" x 9 1/2"
EZFB	(or EZDFB)	169	16" x 9 1/2"
EZFB	(or EZDFB)	189	18" x 9 1/2"
EZFB	(or EZDFB)	209	20" x 9 1/2"
EZFB	(or EZDFB)	229	22" x 9 1/2"
EZFB	(or EZDFB)	249	24" x 9 1/2"
EZFB	(or EZDFB)	269	26" x 9 1/2"
EZFB	(or EZDFB)	289	28" x 9 1/2"
EZFB	(or EZDFB)	309	30" x 9 1/2"

Consult price list for NSF and stainless steel foot and double foot bracket designations.

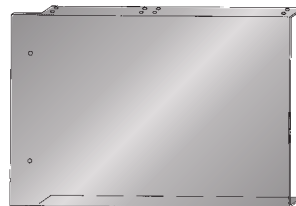

EZFB

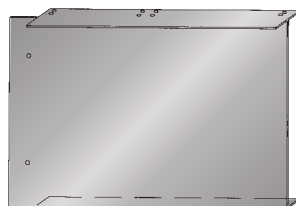

EZDFB

SHELF SPECIFICATIONS

Standard Finish

E-Z Galvanized Steel Shelving (EZGS)

Shall be constructed of 16 gauge G-90, LFO, ASTM A-653 galvanized sheet, with front and rear edges flanged in two directions to provide structural rigidity, and to withstand shelf failure.*See chart on page 4 for allowable loading.

Standard shelf lengths are: 36", 48" and 60". Shelves of virtually any length, however, can be fabricated allowing a "glove fit" regardless of room size, and without custom upcharge.

Stock shelf depths:

EZGS 6"	EZGS 12"	EZGS 18"	EZGS 24"
EZGS 8"	EZGS 14"	EZGS 20"	EZGS 28"
EZGS 10"	EZGS 16"	EZGS 22"	EZGS 30"

Optional shelf materials: 18 gauge, stainless steel, type #304, and .080 aluminum, series #5052.

E-Z Painted Shelving

16 gauge heavy-duty phosphate-primed steel, shall be coated with electrostatically applied plastic powder resin. Standard Colors: white, tan, black and gray. Custom colors available on request.

Technical Data:

2H tested in accordance

Hardness:

with ASTM D-3363

Flexibility: Passes 1/8" (3mm) conical mandrel tested in accordance with ASTM D-522

Impact Resistance: 160/160 direct and reverse tested in accordance with ASTM D-2794

Tensile Strength: (5,300 psi) (373 kg per square centimeter)

Elongation: 3%

